

123 Frontage Rd.

Inspected Address

Fort Worth

City

76555

Zip Code

SCOPE OF INSPECTION

- A. This inspection covers only the multi-family structure, primary dwelling or place of business. Sheds, detached garages, lean-tos, fences, guest houses or any other structure will not be included in this inspection report unless specifically noted in Section 5 of this report.
B. This inspection is limited to those parts of the structure(s) that are visible and accessible at the time of the inspection.
C. Due to the characteristics and behavior of various wood destroying insects, it may not always be possible to determine the presence of infestation without defacing or removing parts of the structure being inspected.
D. If visible evidence of active or previous infestation of listed wood destroying insects is reported, it should be assumed that some degree of damage is present.
E. If visible evidence is reported, it does not imply that damage should be repaired or replaced.
F. THIS IS NOT A STRUCTURAL DAMAGE REPORT OR A WARRANTY AS TO THE ABSENCE OF WOOD DESTROYING INSECTS.
G. If termite treatment (including pesticides, baits or other methods) has been recommended, the treating company must provide a diagram of the structure(s) inspected and proposed for treatment, label of pesticides to be used and complete details of warranty (if any).
H. There are a variety of termite control options offered by pest control companies.
I. There are some specific guidelines as to when it is appropriate for corrective treatment to be recommended.
J. If treatment is recommended based solely on the presence of conducive conditions, a preventive treatment or correction of conducive conditions may be recommended.

1A. TermN8 www.termn8.pro
Name of Inspection Company

1B. 14081A PTLW
SPCS Business License Number

1C. 6119 Greenville Ave.#557
Address of Inspection Company

Dallas
City

TX 75206
State Zip

(210)392-7980
Telephone No.

1D. Kent Keith
Name of Inspector (Please Print)

1E. Certified Applicator [] (check one)
Technician [x]

2. Case Number (VA/FHA/Other)

3. Monday, November 1, 2010
Inspection Date

4A. John Q. Public
Name of Person Purchasing Inspection
Seller [] Agent [] Buyer [x] Management Co. [] Other []

4B. Owner/Seller

4C. REPORT FORWARDED TO: Title Company or Mortgagee [] Purchaser of Service [] Seller [] Agent [x] Buyer [x]
(Under the Structural Pest Control regulations only the purchaser of the service is required to receive a copy)

The structure(s) listed below were inspected in accordance with the official inspection procedures adopted by the Texas Structural Pest Control Service. This report is made subject to the conditions listed under the Scope of Inspection. A diagram must be attached including all structures inspected.

5. Residence Only

List structure(s) inspected that may include residence, detached garages and other structures on the property. (Refer to Part A, Scope of Inspection)

6A. Were any areas of the property obstructed or inaccessible? Yes No

6B. The obstructed or inaccessible areas include but are not limited to the following:

- Attic Insulated area of attic Plumbing Areas Planter box abutting structure
Deck Sub Floors Slab Joints Crawl Space
Soil Grade Too High Heavy Foliage Eaves Weepholes
Other Specify: Wall cavities, behind appliances and beneath flooring, behind furniture and stored items

7A. Conditions conducive to wood destroying insect infestation? Yes No

7B. Conducive Conditions include but are not limited to:

- Wood to Ground Contact (G) Formboards left in place (I) Excessive Moisture (J)
Debris under or around structure (K) Footing too low or soil line too high (L) Wood Rot (M) Heavy Foliage (N)
Planter box abutting structure (O) Wood Pile in Contact with Structure (Q) Wooden Fence in Contact with the Structure (R)
Insufficient ventilation (T) Other (C) Specify: Deck and fence (R) conducive by design

8. Inspection Reveals Visible Evidence in or on the structure:

Table with 4 columns: Active Infestation, Previous Infestation, Previous Treatment. Rows include Subterranean Termites, Drywood Termites, Formosan Termites, Carpenter Ants, and Other Wood Destroying Insects.

8E. Other Wood Destroying Insects Specify: N/A

8F. Explanation of signs of previous treatment (including pesticides, baits, existing treatment stickers or other methods) identified: None

8G. Visible evidence of: Sub termites has been observed in the following areas: Exterior front inside corner to left of front porch (AS)

The conditions conducive to insect infestation reported in 7A & 7B:

9. Will be or has been mechanically corrected by inspecting company: Yes No

If "Yes", specify corrections: _____

9A. Corrective treatment recommended for active infestation or evidence of previous infestation with no prior treatment as identified in Section 8. (Refer to Part G, H and I, Scope of Inspection) Yes No

9B. A preventive treatment and/or correction of conducive conditions as identified in 7A & 7B is recommended as follows: Yes No

Specify reason: Wood deck in contact with house and obstructing view to inspect this area (C)

Refer to Scope of Inspection Part J

10A. This company has treated or is treating the structure for the following wood destroying insects: No

If treating for subterranean termites, the treatment was: Partial Spot Bait Other

If treating for drywood termites or related insets, the treatment was: Full Limited

10B. N/A N/A N/A

Date of Treatment by Inspecting Company _____ Common Name of Insect _____ Name of Pesticide, Bait or Other Method _____

This company has a contract or warranty in effect for control of the following wood destroying insects:

Yes No List Insects: N/A

If "Yes", copy(ies) of warranty and treatment diagram must be attached.

Diagram of Structure(s) Inspected

The inspector must draw a diagram including approximate perimeter measurements and indicate active or previous infestation and type of insect by using the following codes: E-Evidence of infestation; A-Active; P-Previous; D-Drywood Termites; S-Subterranean Termites; F-Formosan Termites; C-Conducive Conditions; B-Wood Boring Beetles; H-Carpenter Ants; Other(s) - Specify _____

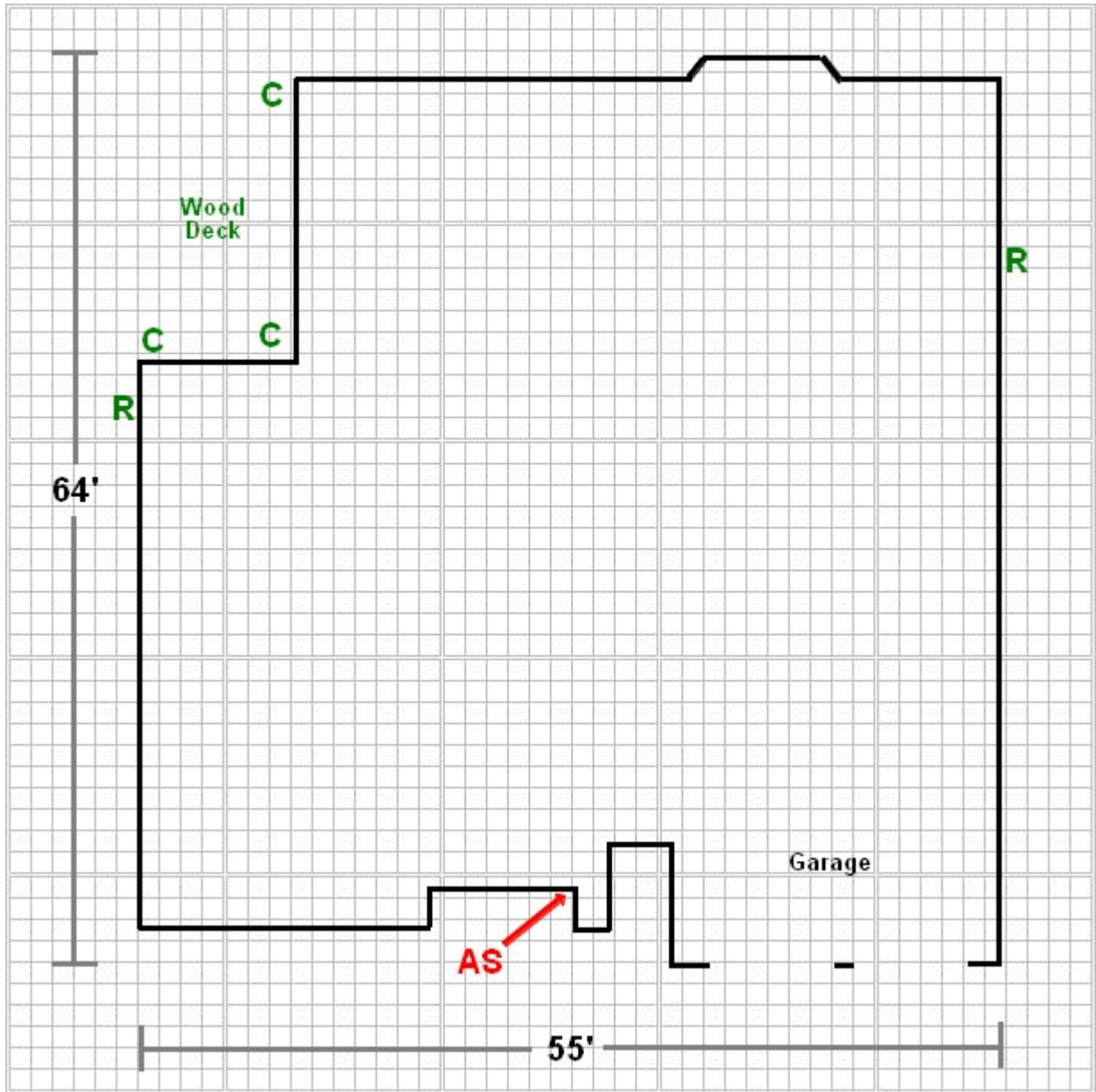

Additional Comments _____

Neither I nor the company for which I am acting have had, presently have, or contemplate having any interest in the property. I do further state that neither I nor the company which I am acting is associated in any way with any party to the transaction.

Signatures:

Notice of Inspection Was Posted At or Near

11A. [Signature] [Signature]
Inspector

Technician #0572351

12A. Electric Breaker Box

Water Heater Closet

Bath Trap Access

Beneath the Kitchen Sink

Approved:

11B. Trace Pharis - Certified Applicator # 27133 PTLW
Certified Applicator and Certified Applicator License Number

12B. Date Posted 8/20/10
Date

Statement of Purchaser

I have received the original or a legible copy of this form. I have read and understand any recommendations made. I have also read and understand the "Scope of Inspection." I understand that my inspector may provide additional information as an addendum to this report.

If additional information is attached, list number of pages: 1

Signature of Purchaser of Property or their Designee

Date

Additional Information and Report Summary

Active termites present in the front exterior corner to the left of the front porch

